

Improving Clinical Research through Consolidation and Innovative Designs Utilizing a Mobile Workforce.

AAMC GIP

August 17, 2023

Dry Lab Research Space

Phenotypes

- Wet Lab Space without a Sink
- Computational / Informatics
- Clinical Research
 - On stage – Includes participants on site
 - Off stage – Participants are engaged at other locations including hospitals, clinics, community, and/or home.

Clinical Research Space

- With “On Stage” Space
 - Includes Public Spaces
 - Looks and acts like a clinic
 - Parking
 - Majority of Clinical Research is completed in “Ambulatory” facilities
- Without “On Stage” Space
 - Hubs adjacent to the “Ambulatory” facilities
 - Outcomes
 - Community Outreach and Engagement

Clinical Research Space – Across Campus (2018 Master Plan)

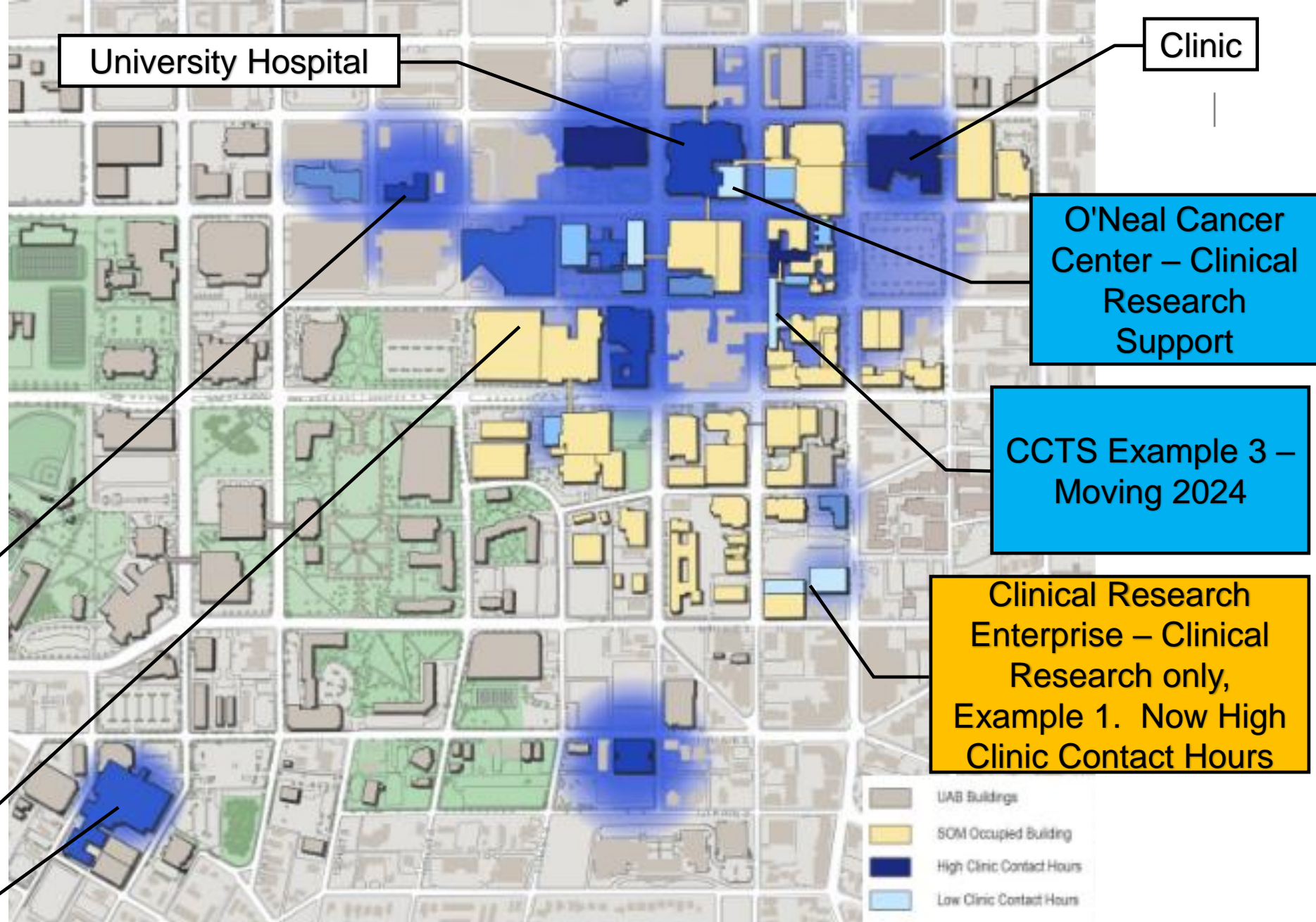

Children's Hospital – Example 2

Hospital Extension

Example 1 – Clinical Research Enterprise (CRE)

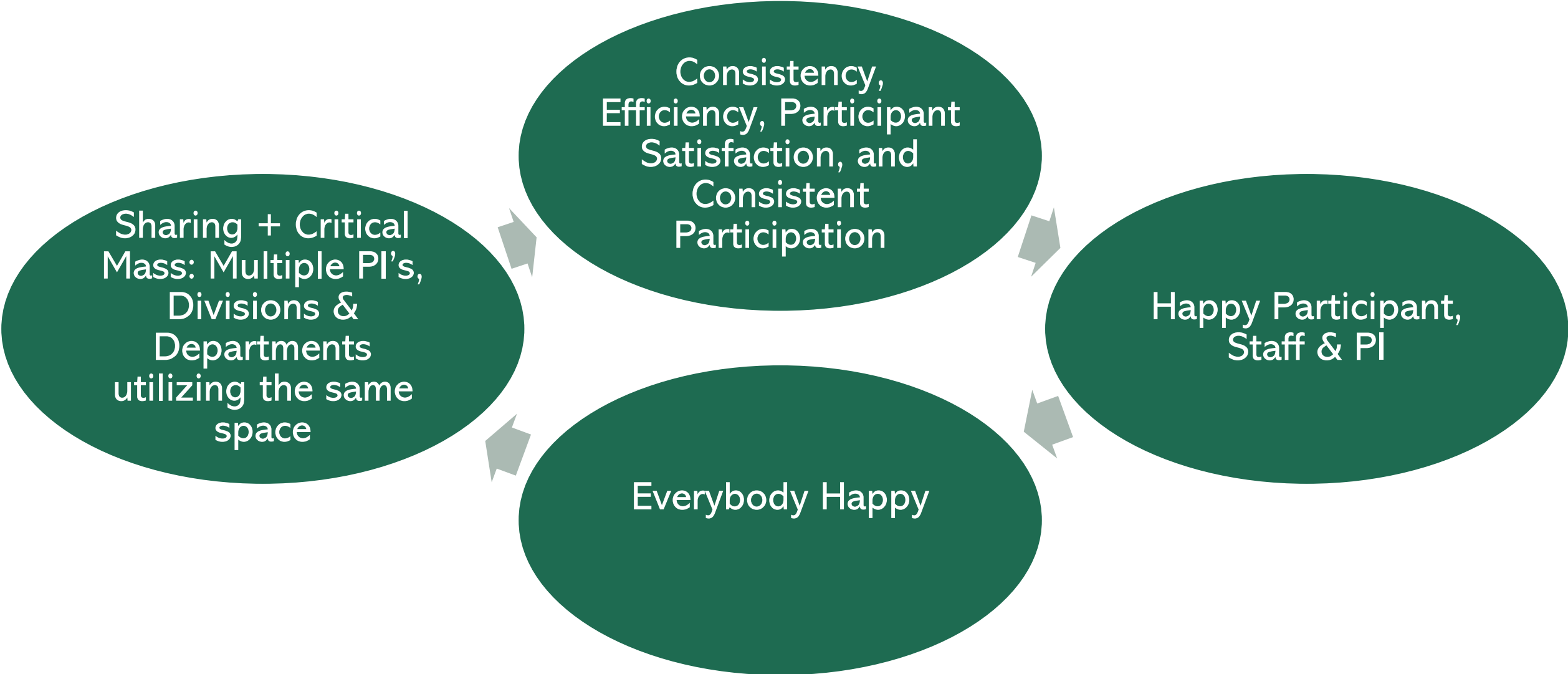

Example 1 – Clinical Research Enterprise (CRE)



Example 1 – Clinical Research Enterprise (CRE)

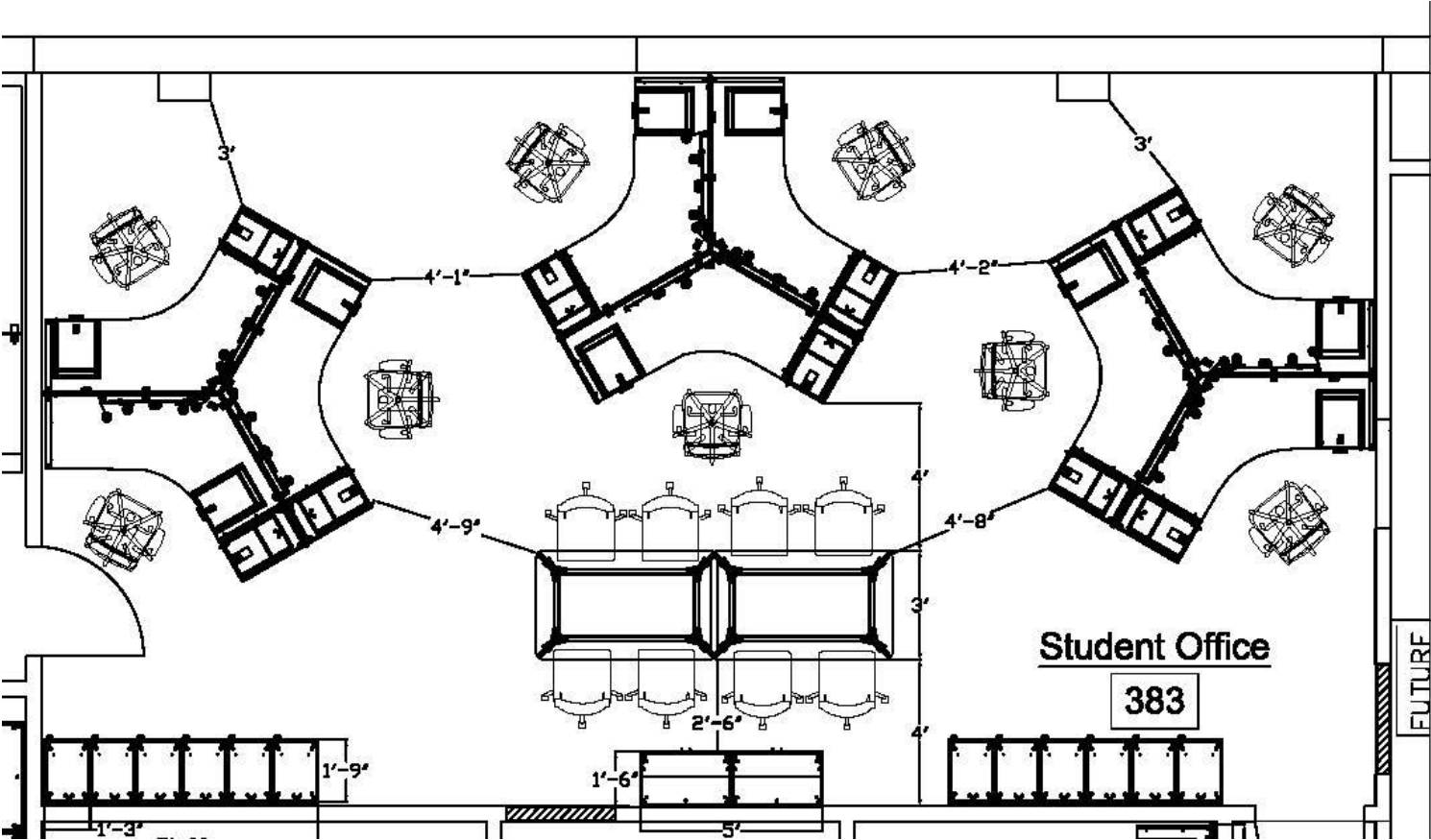

Example 1 – Clinical Research Enterprise (CRE)

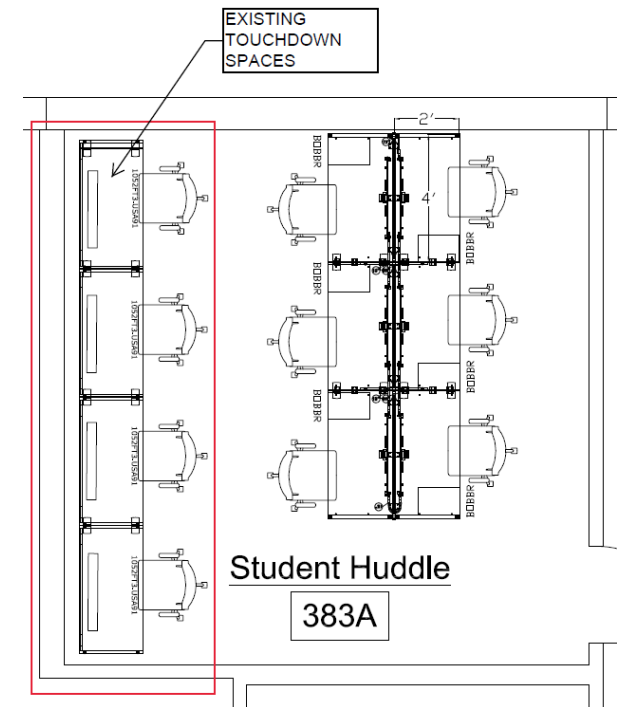

Example 1 – Clinical Research Enterprise (CRE)

- Most CRC's are Completely Mobile
 - Cell phones
 - Laptops
- Mostly Unassigned space
 - Moved to assigned space if onsite 3+ days/week
 - Various types of workspace
 - Open workstations
 - High Bar
 - Private hotels
 - Carrels
 - Huddle Space
- Touch down/hotel space for visitors across the medical center
 - Staff or PI
 - Lockable storage for desk/personal belongings



Clinical Research Space – Key Components

- Clinical Research Operations Manager
 - BS Healthcare Administration: Safety SOP, Standards = Ambulatory and OSHA standards, coordinates between subgroups, Lab processing bandwidth, Biomedical Certifications, Policy Improvement and implementation, workflow management
- Central Scheduling System
- Collaborate & Communicate:
 - Everyone under one roof. Instigates quick conversation, network and resolution.
 - One SOP can be used on multiple projects instead of each one making their own.
- Work Space
 - Hybrid or Fully Remote options are good for some back-of-house staff: Regulatory, accounting, etc.
 - Assigned Desks – Individuals on site 3+ days a week
 - Unassigned Desks: Hotels, Hot Spots, Communication Rooms, Huddle Space

Clinical Research Space - Challenges

Transportation

- University Bus Routes
- Vehicle Availability
- Weather

Resources in Ambulatory (Billable) Space

- Workstations
- Interview Rooms
- IT Access: Network Printers, EMR

Culture Change going to Unassigned Space

- Care Coordinators accustomed to having assigned space
- Sharing printers
- Own storage
- Changing space assignments helped.

Clinical Research Space - Challenges

Utilization

- “Busy” eye test – Make observations
- People in waiting rooms
- Butts in seat
- Look at the schedule and trends for exams
- Research Funding metrics don't apply yet.

Bringing Groups Together

- Expansion space
- Staff workstations
- Integration
- Specialized Equipment

Example 2 - Institute for Cancer Outcomes and Survivorship

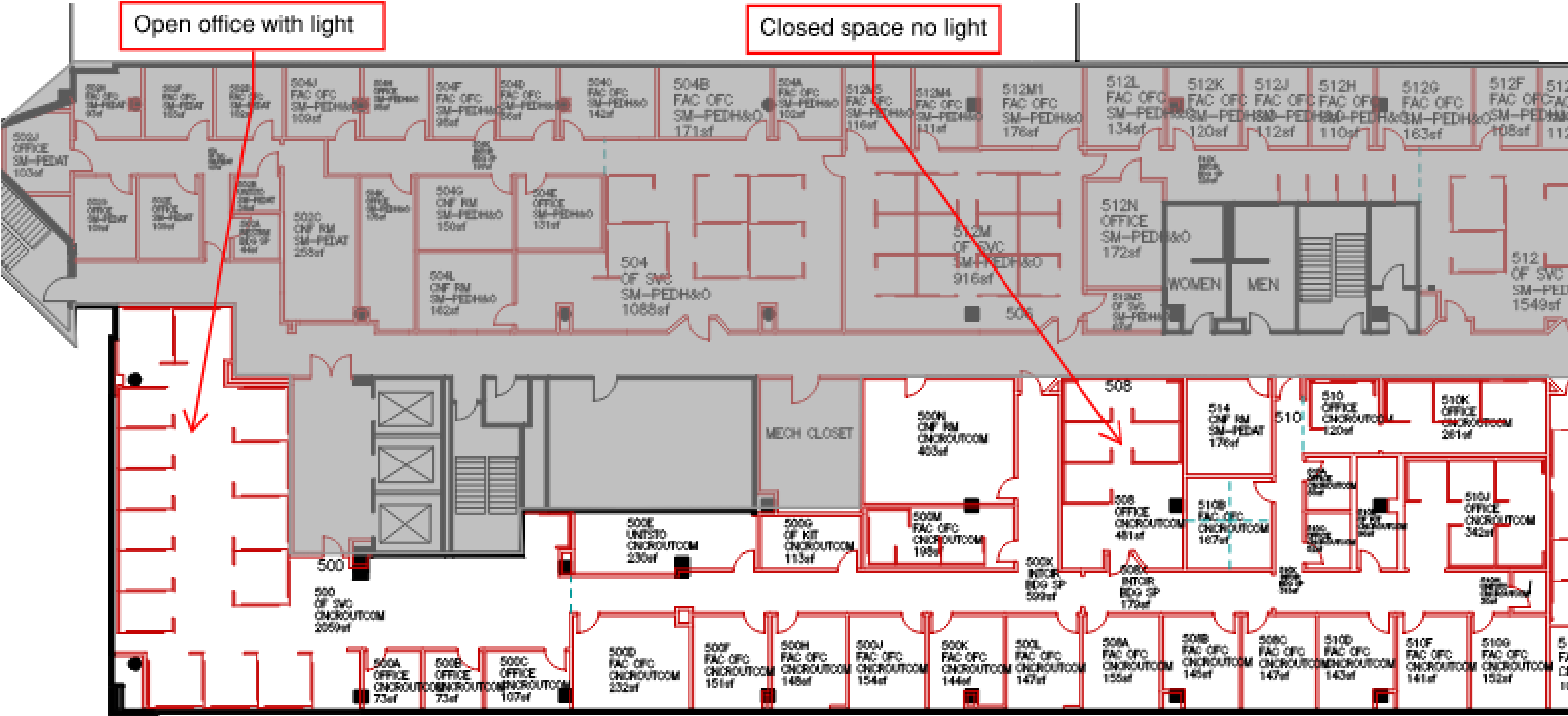

Clinical Research Space: Example 2 – Institute for Cancer Outcomes and Survivorship (Off Stage Only adjacent to the Children’s Hospital Complex)

Open office areas with higher ceiling and light are better environments for CRC’s. They learn from each other. The manager can coach easier. Sound becomes background with the larger number of individuals. Doors were added during covid and improved the situation more. CRC’s see participants in Children’s Hospital.



Clinical Research Space: Example 2 – Institute for Cancer Outcomes and Survivorship



Above: CRC's in an enclosed area with no light. Sound is more of a problem. Fewer opportunities to learn from each other. Manager cannot oversee the quality of their work.



Left: Another view of the open office CRC Space.

Clinical Research Space – Storage

- Projects are starting to become more digital. However, not there yet.
- Binders not being used. Don't we all love the 7-year (at least) rule! Digitize or Separate Storage Facility.
- Binders in use: Double Lock.
- Supplies – Not for Post-It notes and pencils. The clinical kind provided by projects. i.e. test tubes, blood draw, “cups”, kits, and devices.



Example 3 – Center For Clinical and Translational Science (CCTS) Off Stage visiting multiple clinical facilities.



- New Space will come online late 2024
- Communication Rooms or “Zoom” Rooms – Helps with Monitors
- Cubes have slider door
- Huddle Space – Also helps with Monitors
- Massive Supply Room.
- Wellness (prayer, time out, etc.)

Questions